

## NUMBER

**TDS-3542**

## PRODUCT DESCRIPTION

Anaconda food grade 90° fittings

## PRODUCT RANGE

Anaconda food grade fittings for Sealtite

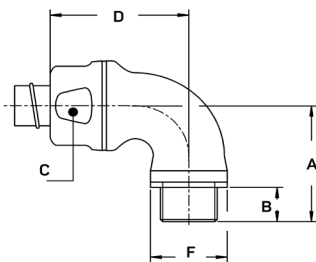

## ISO 90° FITTING, COMPACT, FOOD GRADE FITTING, MALE, STAINLESS STEEL AISI-316

THREAD ISO	SEALTITE SIZE (NW)	MIN. INTERNAL BORE (MM)	DIMENSIONS IN MM					STANDARD PACKAGE	ARTICLE NUMBER	WEIGHT (KG/100)
A	B	C	D	F						
M20 x 1,5	1/2"	13,8	44	13	30	49	27	10	742.920.9	16,9
M25 x 1,5	3/4"	18,5	49	13	36	55	32	5	742.925.9	25,9
M32 x 1,5	1"	23,8	58	15	44	63	42	5	742.932.9	43,0
M40 x 1,5	1 1/4"	31,8	68	16	53	73	50	2	742.940.9	60,7

## APPLICATION AREA

Anaconda 90° compact hygienically designed, stainless steel AISI-316 food fittings can be used with all types of Anaconda Sealtite conduits (except CNP). These stainless steel compact food fittings are designed with rounded corners and have a smooth contourless profile to minimise the risk of bacteria deposits and to promote easy cleaning. They display excellent resistance to corrosion.

## MATERIAL & CONSTRUCTION:

**Construction:** Stainless steel AISI-316 fitting, consisting of 6 parts (counter nut, upper seal, clamping ring, ferrule, 90° body and flat gasket).

**Material:** Counter nut and 90° body are stainless steel AISI-316 and the ferrule is from nickel plated brass. The flat gasket is made of special FDA approved PTFE. The blue rubber upper seal and clamping ring are made of TPE in accordance with FDA / CFR 21.

**Temperature:** -40 °C till +105 °C.

**Colour:** Metal shining.

## CLASSIFICATION ACCORDING TO NEN-EN-IEC 61386:

**Protection class:** IP 68 according EN 60529, IP69 according DIN 40050-9 (till 40 Bar high pressure).